

# Katima



**Katima**  
*A Neighborhood with Style*  
*Another Kiepersol Community*

For lot information please call:

Bob Burnett  
 (903) 894-9330  
 TYLER, TEXAS  
 www.kiepersol.com

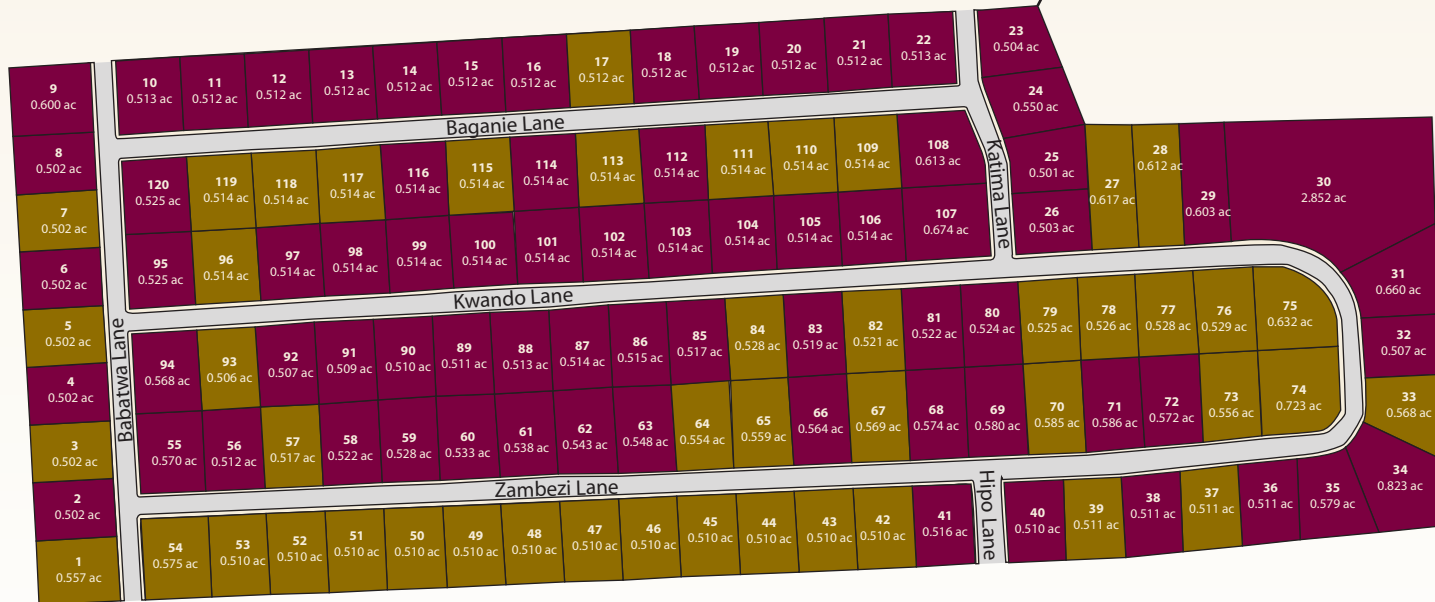
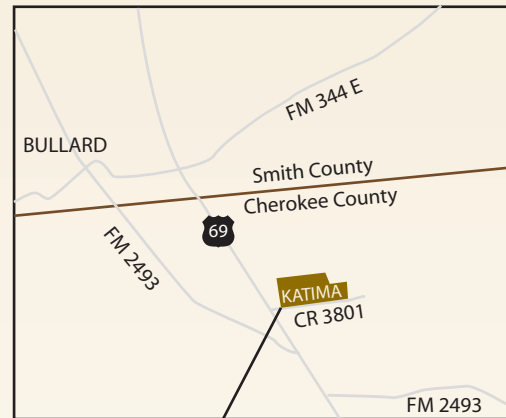

LOT #	PRICE
1	\$30,000
2	SOLD
3	\$30,000
4	SOLD
5	\$30,000
6	SOLD
7	\$30,000
8	SOLD
9	SOLD
10	SOLD
11	SOLD
12	SOLD
13	SOLD
14	SOLD
15	SOLD
16	SOLD
17	\$30,000
18	SOLD
19	SOLD
20	SOLD
21	SOLD
22	SOLD
23	SOLD
24	SOLD
25	SOLD
26	SOLD
27	\$25,000
28	\$25,000
29	SOLD
30	SOLD
31	SOLD
32	SOLD
33	\$34,000
34	SOLD
35	SOLD
36	SOLD
37	\$30,000
38	SOLD
39	\$33,000
40	SOLD
41	SOLD
42	\$30,000
43	\$30,000
44	\$30,000
45	\$30,000
46	\$30,000
47	\$30,000
48	\$30,000
49	\$30,000
50	\$30,000
51	\$30,000
52	\$30,000
53	\$30,000
54	\$30,000
55	SOLD
56	SOLD
57	\$31,000
58	SOLD
59	SOLD
60	SOLD

LOT #	PRICE
61	SOLD
62	SOLD
63	SOLD
64	\$30,000
65	\$30,000
66	SOLD
67	\$30,000
68	SOLD
69	SOLD
70	\$30,000
71	SOLD
72	SOLD
73	\$32,000
74	\$34,000
75	\$34,000
76	\$31,000
77	\$31,000
78	\$30,000
79	\$30,000
80	SOLD
81	SOLD
82	\$30,000
83	SOLD
84	\$30,000
85	SOLD
86	SOLD
87	SOLD
88	SOLD
89	SOLD
90	SOLD
91	SOLD
92	SOLD
93	\$30,000
94	SOLD
95	SOLD
96	\$30,000
97	SOLD
98	SOLD
99	SOLD
100	SOLD
101	SOLD
102	SOLD
103	SOLD
104	SOLD
105	SOLD
106	SOLD
107	SOLD
108	SOLD
109	\$30,000
110	\$30,000
111	\$30,000
112	SOLD
113	\$30,000
114	SOLD
115	\$30,000
116	SOLD
117	\$30,000
118	\$30,000
119	\$30,000
120	SOLD

 Lot Sold

Revision Date: 7-5-11  
 Lot prices subject to change without notice